



# TEUS

Rigid Arm  
manipulator

MADE IN  
ITALY



[www.maniflex.eu](http://www.maniflex.eu)

Operating pressure  
 **7** Bar

Maximum capacity  
 **1850** Kg

Working radius  
 **5000** mm

The Maniflex TEUS manipulator is our largest pneumatic manipulator, designed to transport loads weighing almost two tons, while maintaining ergonomics and safety in moving loads in any direction.

It can be considered an alternative to small overhead cranes and be equipped with customized gripping tools, designed and built according to the specific needs of the industry of use.

The multiple installation options allow it to be easily integrated into any production line or industrial process, ensuring a smooth and optimized workflow.

# Tecnical Parameters

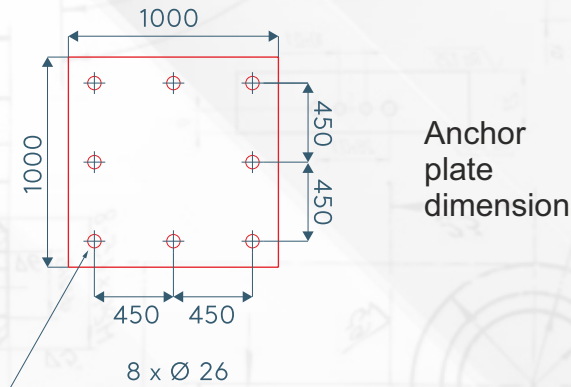
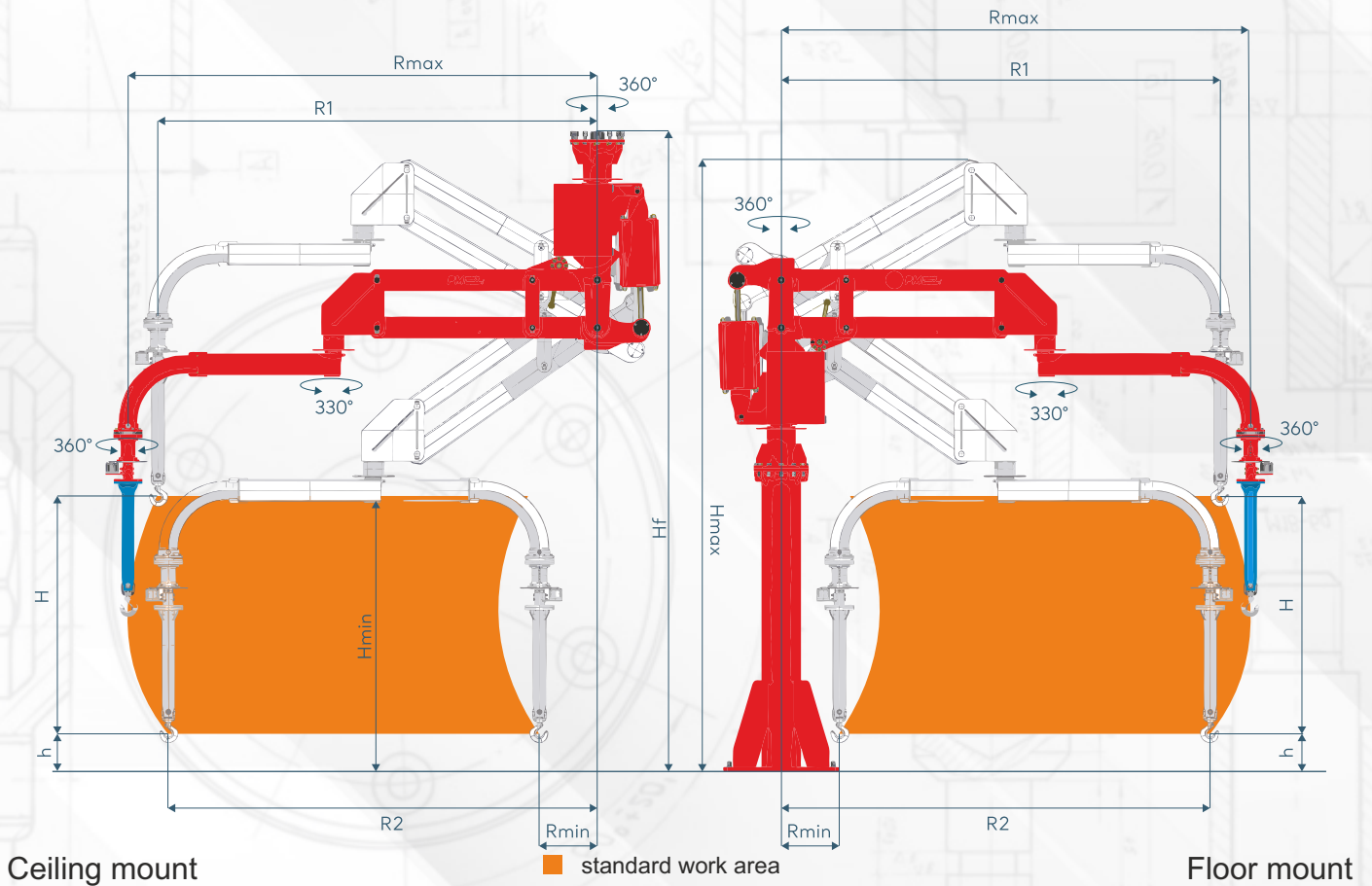

## TECHNICAL DATA

TEUS

		780	950	1100	1300	1600	1850
Max. capacity / kg		780	950	1100	1300	1600	1850
Max. working radius / mm	Rmax	5000	4500	4000	3500	3000	2500
Min. working radius / mm	Rmin	1342	1250	1139	1034	920	800
Vertical lift / mm	H	3000	2750	2450	2150	1830	1500
Lowest vertical lifting capacity / mm	h	200	200	200	200	200	200
Maximum height / mm	Hmax	5902	5652	5350	5052	4734	4405
Max. ceiling height / mm	Hf	5540	5452	5275	5132	4980	4822
Min. Height / mm	Hmin	2000	2000	2000	2000	2000	2000
Radius 1 / mm	R1	4520	4060	3608	3156	2707	2259
Radius 2 / mm	R2	4415	3964	3523	3081	2643	2207

\*Size may vary and can be adapted to customer needs.